

3. Using a pair of snap-ring pliers (2), remove snap-ring (3) from bottom of ball joint (1).

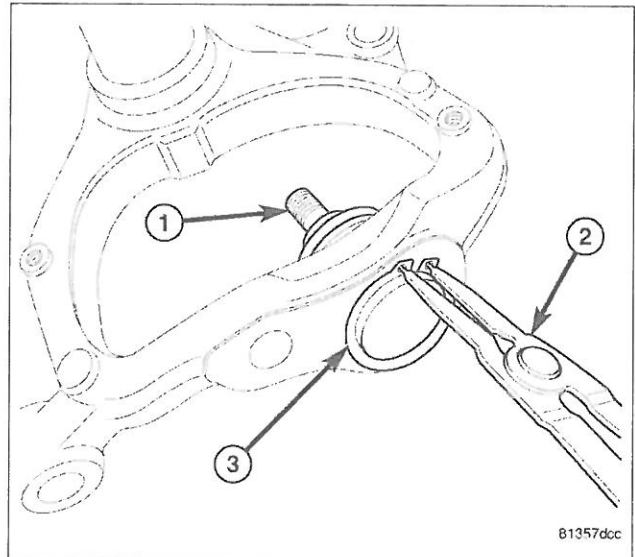

4. Install halves of Support Clamp (1), Special Tool 9320-1, over ball joint (2) and around knuckle surface (3) as shown. Install and snug Support Clamp (1) screws from underside.

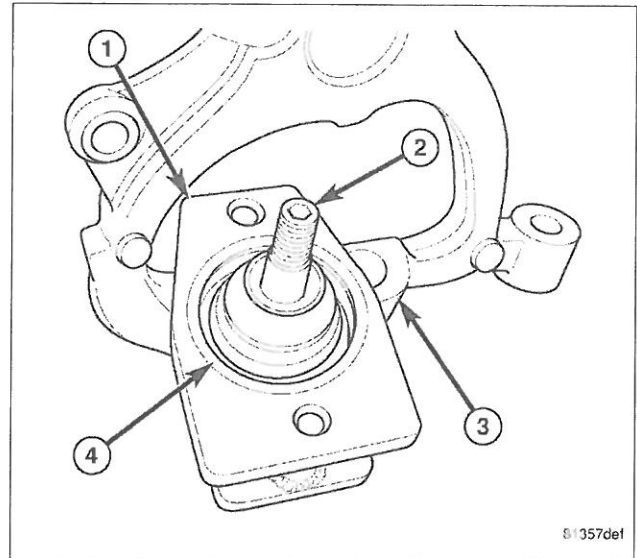

5. Position knuckle (1) over tools guiding top of ball joint inside of Receiver (6), then hand tighten Press screw-drive (4) until Remover (3) comes into contact with bottom of ball joint (2).

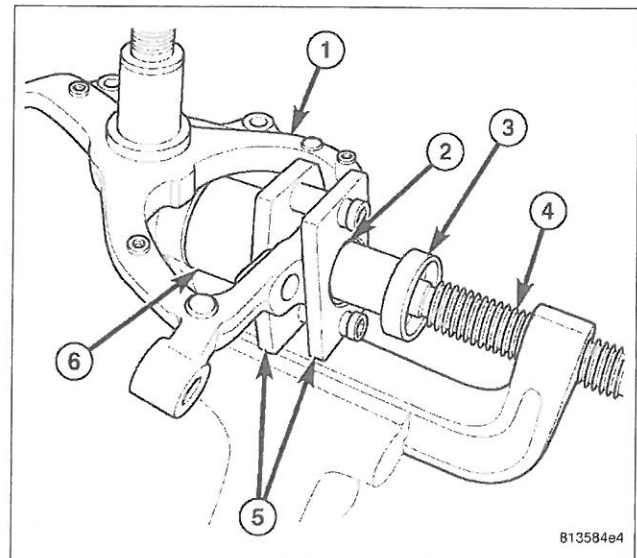

Note: When positioning knuckle over tools, make sure Receiver, Special Tool 9320-5, sets into recessed area (4) of Support Clamp, Special Tool 9320-1.

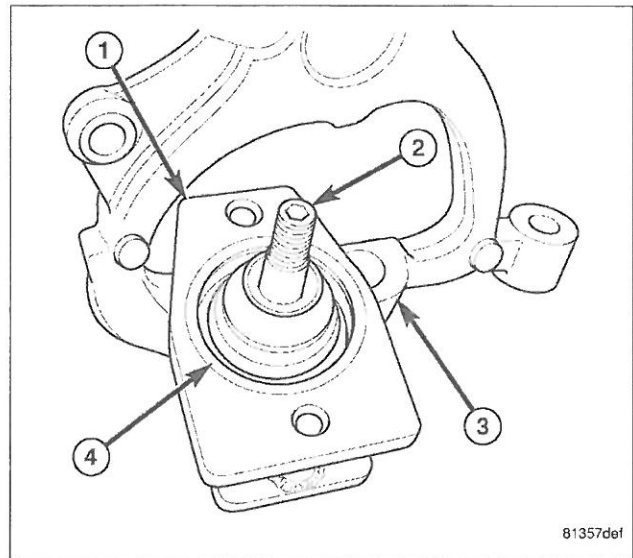

6. Tighten Press screw-drive (4) forcing ball joint out of knuckle (1) and into Receiver (6).
7. Loosen screw-drive (4) and remove knuckle (1) from Press. Remove ball joint from Receiver (6).

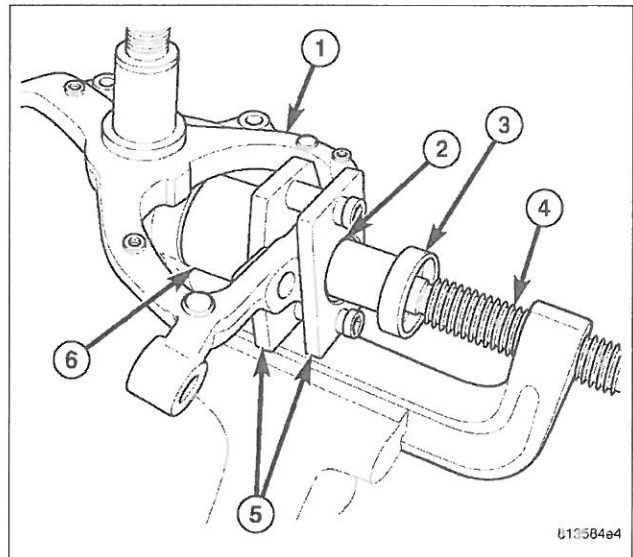

8. Remove Support Clamp (1) from knuckle (3).

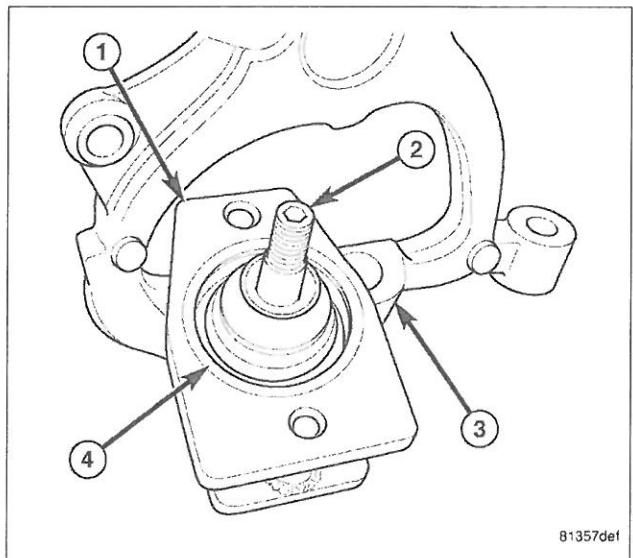

ASSEMBLY - BALL JOINT

Note: To perform this procedure it works best to mount Press (3), Special Tool C-4212F, in a vise and hold the component in your hands.

1. Place Installer (1), Special Tool 9320-4, into cup area of Press (3), Special Tool C-4212F, as shown and tighten set screw.
2. Place Remover (2), Special Tool 9320-3, onto end of screw-drive of Press (3), Special Tool C-4212F, as shown. **Note:** This is the reverse of how Remover is installed on screw-drive for removal.

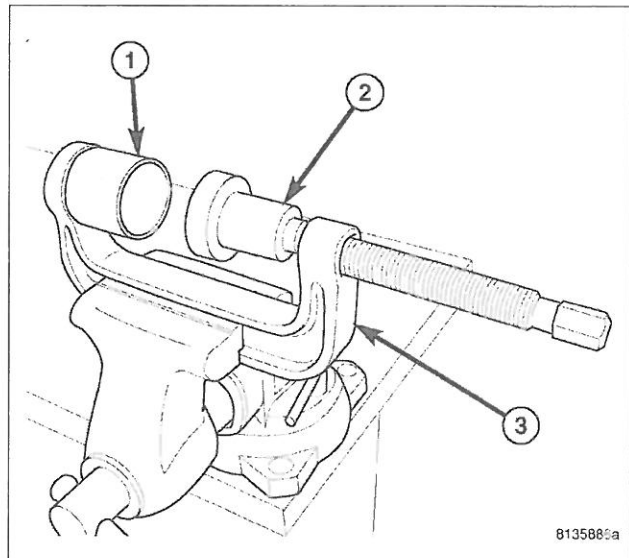

813588a

3. Start NEW ball joint (1) into bore of knuckle (2).

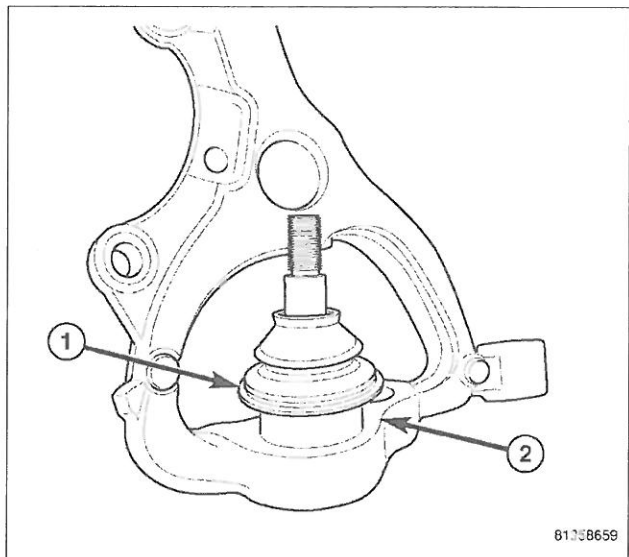

81358659

4. Position knuckle (1) over tools guiding top of ball joint inside of Installer (5) until outside flange of ball joint (4) comes into contact with Installer, then hand tighten Press screw-drive (3) until Remover (2) comes into contact with bottom of knuckle (1).
5. Using hand tools, tighten screw-drive (3), pressing ball joint into knuckle until flange (4) comes to a stop against the knuckle.
6. Loosen screw-drive and remove knuckle from Press.

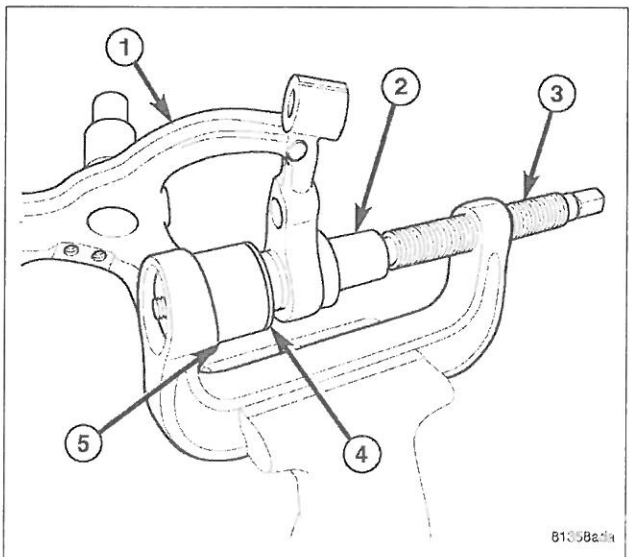

81358a.1a

7. Install snap-ring (3) into groove on bottom of ball joint.
8. Inspect ball joint for proper fit. Make sure seal boot is uniform and wire rings are in place.

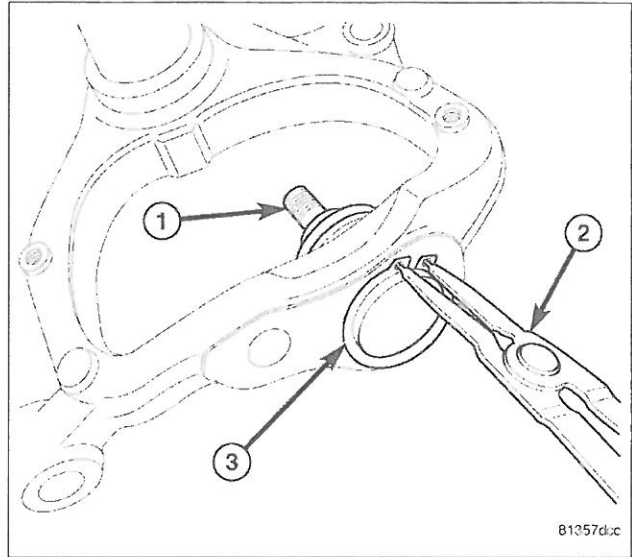

INSTALLATION

1. If shield needs to be installed on knuckle, place shield in place and attach to knuckle using 3 screws. Tighten screws to 10 N·m (89 in. lbs.) torque.
2. If hub and bearing needs to be installed on knuckle, perform the following:
 - a. Slide hub and bearing onto knuckle spindle.
 - b. Install hub nut (1) on end of spindle. Tighten hub nut to 250 N·m (184 ft. lbs.) torque.
 - c. Install dust cap (2).

